

RETROFIT 210B-2SRA QMP VACUUM SYSTEM ASSEMBLY - PAGE 01

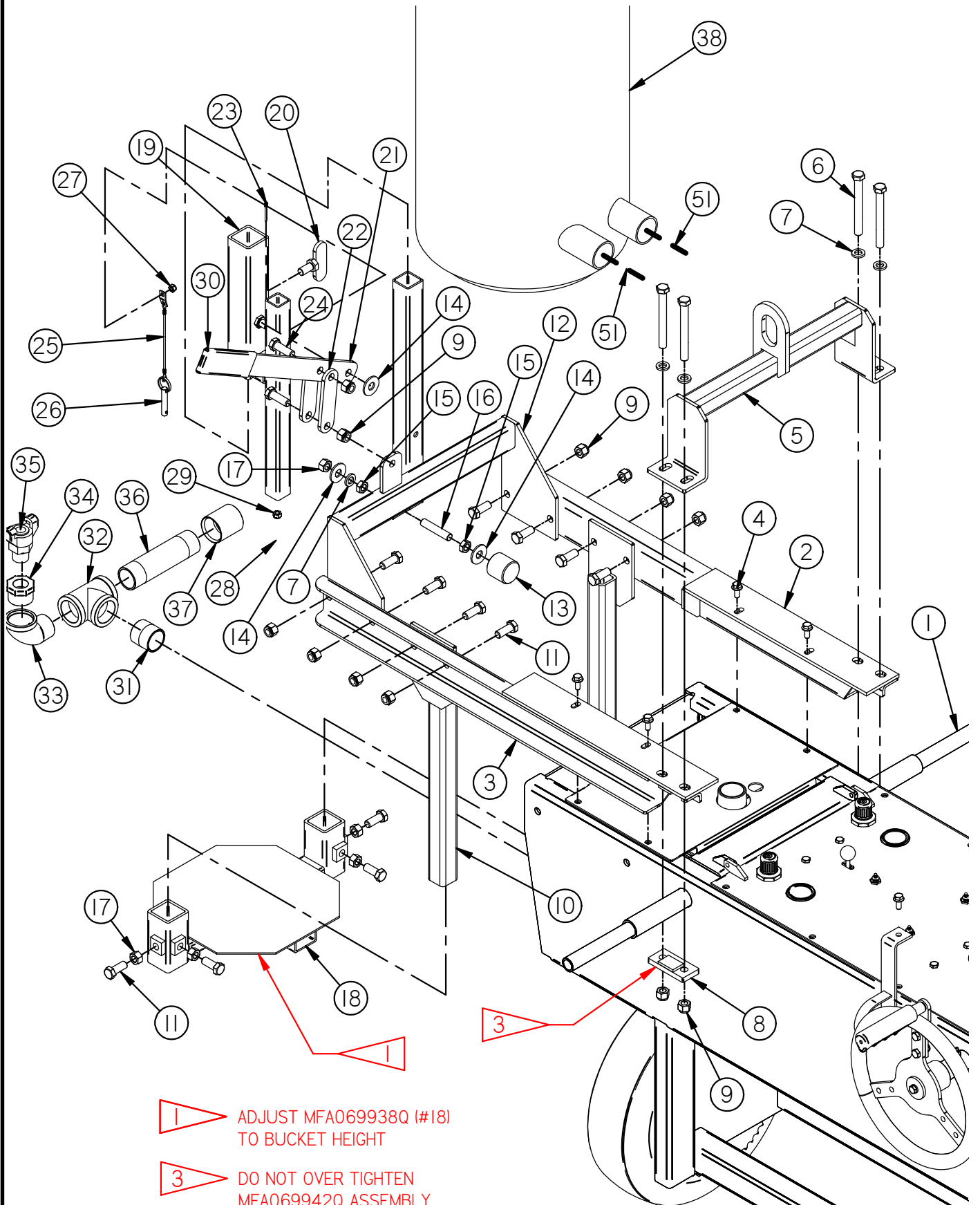

96961Q-1 MIS ASSEMBLY

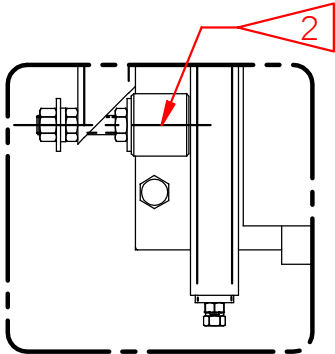
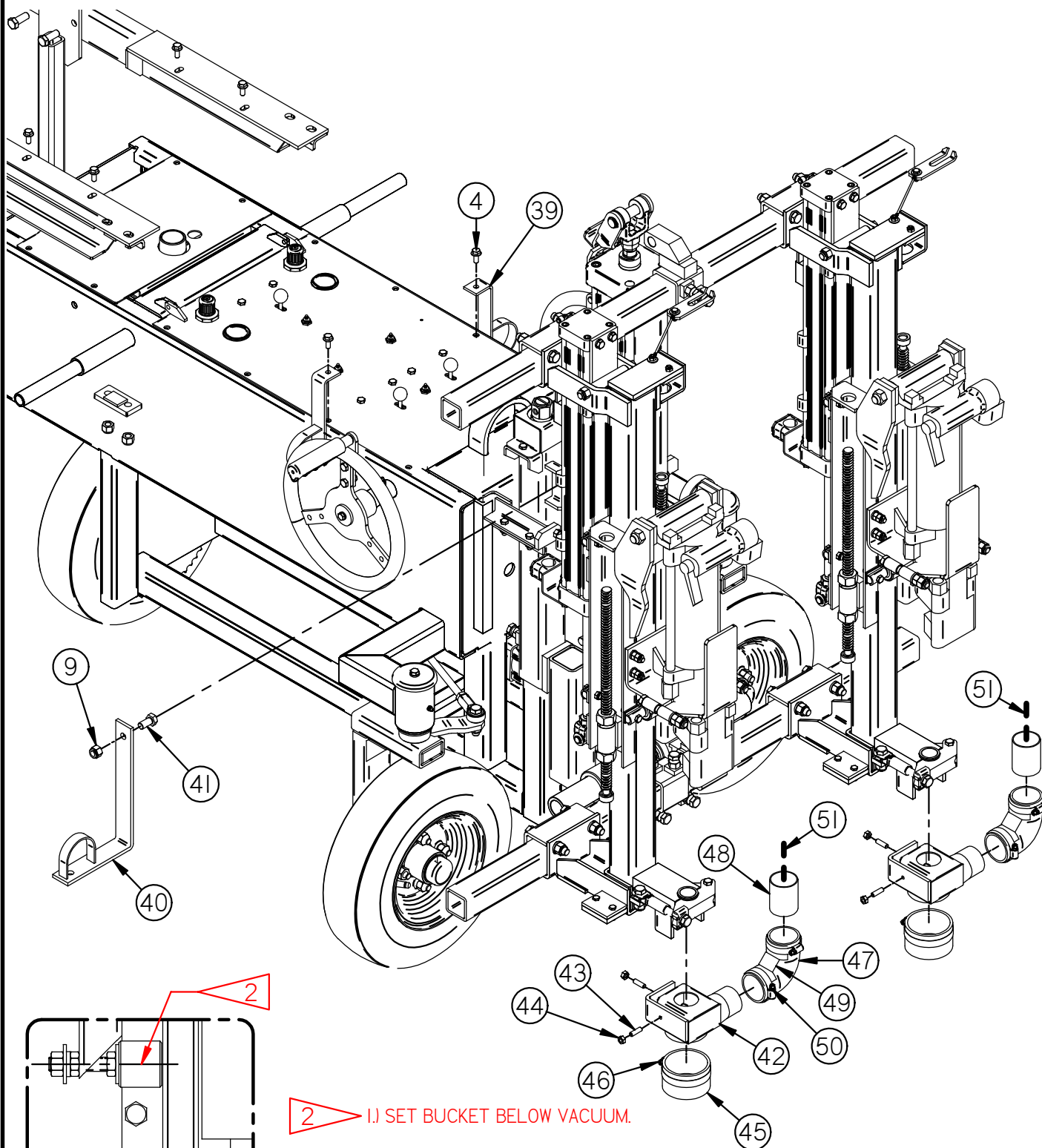

DETAIL A

- 2 I.) SET BUCKET BELOW VACUUM.
- 2.) ADJUST THE BUCKET AND VACUUM SO THEY ARE POSITIONED SQUARELY ON THE PLATFORM BELOW.
- 3.) ADJUST THE SPACER (#13) SO THAT IT IS FLUSH AGAINST THE TUBE (#19).

RETROFIT 210B-2SRA QMP VACUUM SYSTEM ASSEMBLY - PAGE 03

Item No.	Part No.	Quantity	Description
1	FNG814300	1	210B-2 SRA (2-GANG DRILL)
2	MFA069940Q	1	RETROFIT 210B-2 SRA LEFT ARM
3	MFA069939Q	1	RETROFIT 210B-2 SRA RIGHT ARM
4	25175 BLT	6	5/16 NC X .75" LG. HEX FLG HEAD BOLT
5	MFA069941Q	1	210B-2 SRA RETROFIT LIFTING BALE
6	2572BLT	4	1/2" NC X 4 1/2" BOLT, GR. 5
7	2831WAS	5	7/8" OD X 1/2" ID WASHER 10GA.
8	MFA069942Q	2	210B-2 SRA RETROFIT BOLT PLATE
9	2734NUT	16	1/2" NC NYLON INSERT LOCKNUT
10	MFA069936Q	2	210B-2 SRA QMP VAC SYSTEM LEG
11	2560BLT	12	1/2" NC X 1.25" HX HD BOLT
12	MFA069937Q	1	QMP SLIDE RECEIVER
13	MFA06997Q	1	NYLON SPACER, QMP VAC SYSTEM
14	2830 WAS	3	1/2" STD. FLAT WASHER
15	27696 NUT	2	1/2" NF HEX JAM NUT (RT. HND.)
16	25641 BLT	1	1/2"-13 X 2.50" FULLY THREADED STUD
17	2732 NUT	5	1/2" NC STANDARD NUT
18	MFA069938Q	1	210B-2 SRA QMP VAC SYSTEM MT. PLT.
19	MFA069933Q	1	QMP VAC ADAPTER - (MOD 210B-2 SRA)
20	MFA069903	1	SET SCREW - DUST COLLECTION
21	MFA0699040	1	RAISE/LOWER LEVER - MACRO DUST COLLECTION
22	MFA069906	2	FRAME CLAMP LONG
23	30221 PIN	1	1/8" X 1-1/4" COTTER PIN
24	2562 BLT	2	1/2" NC X 1.50" HX HD TAP BOLT
25	3031PIN	1	LANYARD W/TAB ONE END
26	3029PIN	1	LOCK PIN

RETROFIT 210B-2SRA QMP VACUUM SYSTEM ASSEMBLY - PAGE 04

Item No.	Part No.	Quantity	Description
27	2716NUT	1	1/4" NC NYLON LOCK NUT
28	MFA0699700Q	1	QMP 2-PORT COLLECTOR MOUNTING BOLT
29	2719 NUT	1	5/16" NC NYLON INSERT LOCKNUT
30	18206GRO	1	LEVER GRIP
31	212701 PFT	1	1-1/4" CLOSE NIPPLE
32	2104 PFT	1	1-1/4" PIPE TEE
33	21600 PFT	1	1-1/4" STREET ELL
34	20780 PFT	1	1-1/4" TO 3/4" BUSHING
35	2006FIT	1	3/4" MALE PIPE TO QUICK COUPLER
36	21276 PFT	1	1-1/4" X 6" NIPPLE
37	21475 PFT	1	FULL COUPLING, 1-1/4NPT (STEEL)
38	96951Q MIS	1	MACRO QMP VACUUM
39	MFA06994	2	SMALL HOSE HOLDER (210B-2 SRA)
40	MFA06995	2	LARGE HOSE HOLDER (210B-2 SRA)
41	2559BLT	2	1/2" X 1" BOLT
42	MFA069913	2	DUST COLLECTOR HEAD
43	2521 BLT	4	5/16-18 X 1" SET SCREW
44	2717 NUT	4	5/16 UNC HEX NUT (ZP, GR. 5)
45	190406 HOS	2	3" COLLECTOR HOSE (2" LONG PIECE)
46	19503 CLP	2	WORM GEAR HOSE CLAMP (3 - 4")
47	19045 HOS	2	2" 90 DEG. SILICONE HOSE COUPLER
48	MFA069910_12	2	DUST HEAD ROUND TUBE
49	MFA069914	2	90 DEG. ELBOW CLAMP
50	195025 CLP	4	WORM GEAR HOSE CLAMP (1-1/2" - 2-1/2")
51*	19255 HOS	2	2" VACUUM HOSE